



Renovated Split Foyer with Carport Set on a Picturesque 1+ Acre Lot Backing to Woods



8216 Seneca View Drive | Gaithersburg, MD 20882



CHRIS NAGEL

Ranked in the Top 3% of Realtors Nationwide

www.ChrisNagelHomes.com

Office: 301-340-8700 x155
Mobile: 301-787-8001
Chris@Coakleyrealty.com

Office: 301-340-8700 x103
Mobile: 301-814-3200
MPRose57@aol.com



MICHAEL P. ROSE

Ranked in the Top 1% of Realtors Nationwide

www.MichaelPRose.com



Gorgeous remodeled 3BR+Den/2FB all brick split foyer situated on quiet dead end street and picturesque 1+ acre lot backing to woods. Located in highly ranked Damascus school district and minutes from downtown this home features approximately 2,100 square feet of living area on two levels including newly finished hardwood flooring, new

carpet, updated LED lighting, chair and chair mouldings and custom painting throughout.

Inviting foyer entry with new dura-ceramic tile flooring, chandelier and refinished hardwood stairs; living room with bay window and adjacent dining room both with decorative beams and refinished hardwood flooring; French door access to enormous deck from dining room overlooking backyard; remodeled gourmet kitchen with painted cabinetry, quartz countertops with stainless undermount sink and pull-out sprayer faucet, stainless steel Maytag appliances, subway tile backsplash and dura-ceramic tile flooring; main level master bedroom suite with new carpet and dual closets; renovated top-to-bottom ceramic tile full bath features tub/shower with sliding glass door enclosure and vanity with quartz countertops; two additional bedrooms on upper level with new carpet and lighting.

Fully finished daylight walk-out lower level features a recreation room with recessed lighting and propane gas fireplace, den/office with new carpet, and full bath; laundry/storage room area with new Whirlpool washer/dryer and laundry tub. The flat backyard is perfect for entertaining with the newly redone deck and over-sized storage shed. Other features include newer roof, well pump, no HOA and nearby Upper Magruder Branch Park.



Chris Nagel



Michael P. Rose

Main Level

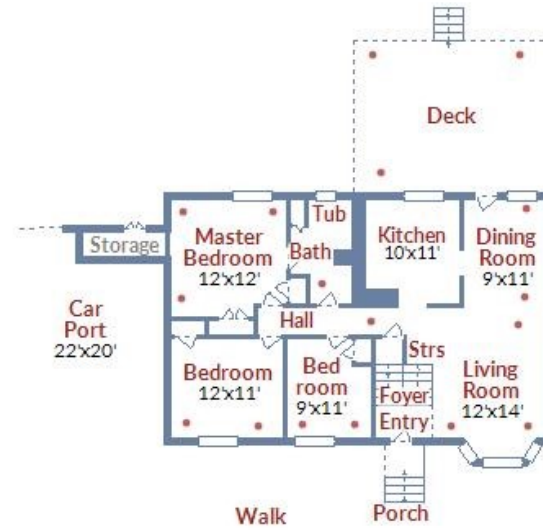

Lower Level



- Year Built:** 1973
- Legal Subdivision:** Silver Crest
- Est. RE Taxes:** 4,155.36 (FY 2020)
- Lot Size:** 1.05 Acres or 46,150 Square Feet
- Exterior:** Brick Front & Side, Siding
- Heat:** Oil
- Cool:** Electric
- Hot water:** Electric

- Elementary School**
Clearspring
- Middle School**
John T. Baker
- High School**
Damascus

Information in this brochure is deemed to be accurate, but should not be relied upon without verification.

